



## **Decibel® Conference**

### The huddle room reimaged

The largest pod of them all, the Decibel® Conference Pod is the size of 2 Decibel® Double booths, designed for 6-8 users. Its modular design makes it a quick and easy alternative to building out conference rooms and provides superior acoustics and privacy for meetings.

A better way to make your day, productive!

## Differentiators

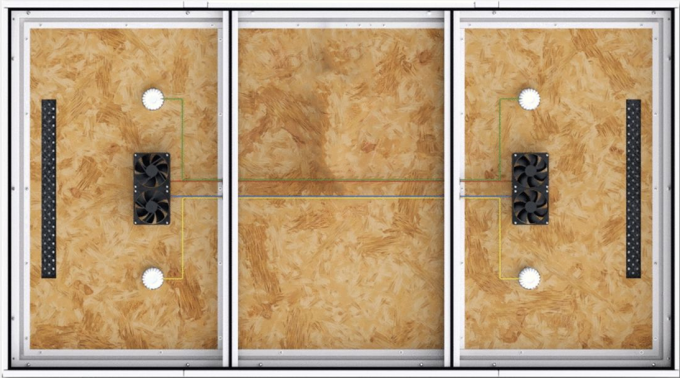

### KEEPING YOU COOL

## QuietFlow™

Our proprietary QuietFlow™ system is designed to keep you cool by quietly circulating the air inside the booth while ensuring sound doesn't escape.

The design of the Spaceworx QuietFlow™ airflow system allows the fresh air to flow in smoothly, powered by energy-efficient fans, and forcing stale air out through strategically positioned exhaust vents, ensuring that a proper balance oxygen level is maintained throughout the pod.

### QUIETWORX™ ACOUSTICS

## Reducing Decibels

Three layers of soundproofing material removes all distractions, giving everyone in the office a moment of peace.



## Technical Specifications



- (2x or 3x the Decibel Double Pod)
- **Exterior:** 85"H x 86"W x 93"D\*
- **Interior:** 82"H x 82"W x 88"D\*
- **Door:** 36" x 80" RH or LH
- **Weight:** Approx 1800 lbs
- **Power:** 6-8ft Power cord for Standard 110-120v outlet plug  
3500- 4500k LED lighting
- **Light switch for lighting & ventilation (motion sensor optional)**
- **Quietflow™ Ventilation (2 fans)**
- **Power Outlet & USB ports.**  
Optional data port
- **Passage latching door handle (optional locking handle)**
- **Acoustical rubber door seal**
- **Powered coated steel frame (black or white)**
- **High pressure laminate side panels (black or white, woodgrains for upcharge)**
- **Anti-shatter acrylic windows**
- **Charcoal PET acoustical felt**
- **Quietworx™ acoustical upholstery (optional colors on walls)**
- **Black Carpet**
- **Adjustable leveling feet**
- **Back panel clear window (solid optional)**
- **MeetSmart™ lounge and table configuration**
- **Fireshield™ (patent pending) fire suppression system (optional)**
- **Design Patent (Pending)**

\*Dimensions may vary slightly

A better way to make your day, productive!

Front View

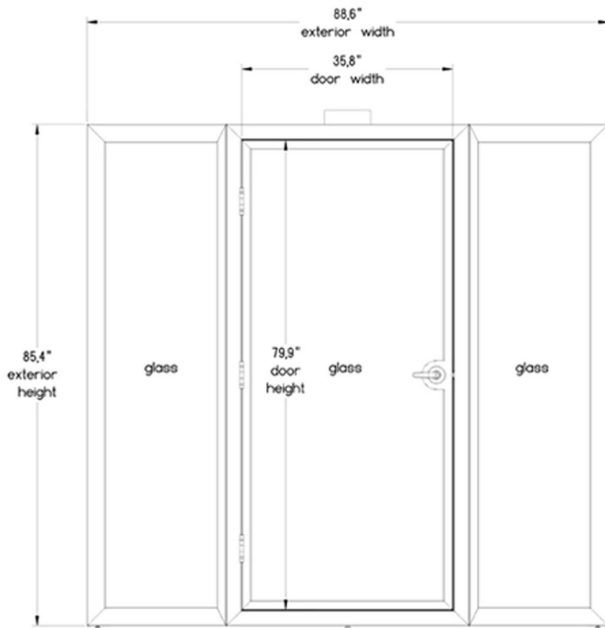

Rear View

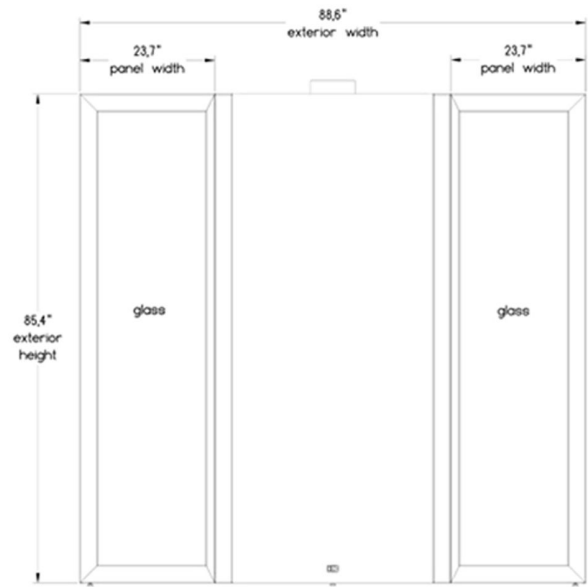

Side View

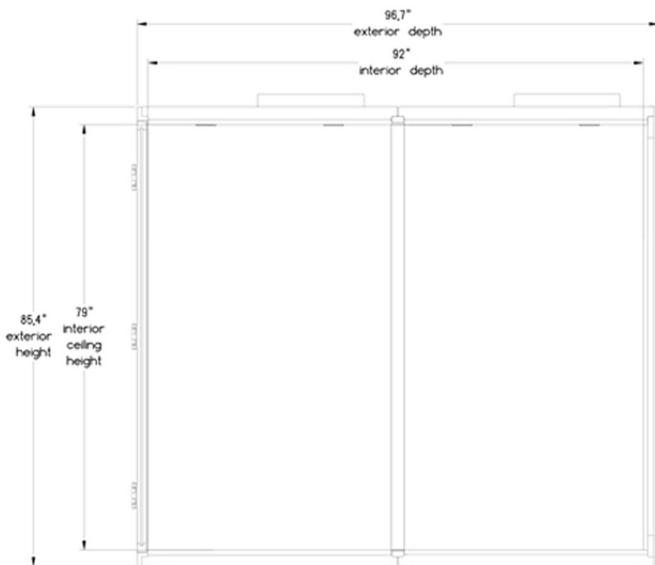

Top View

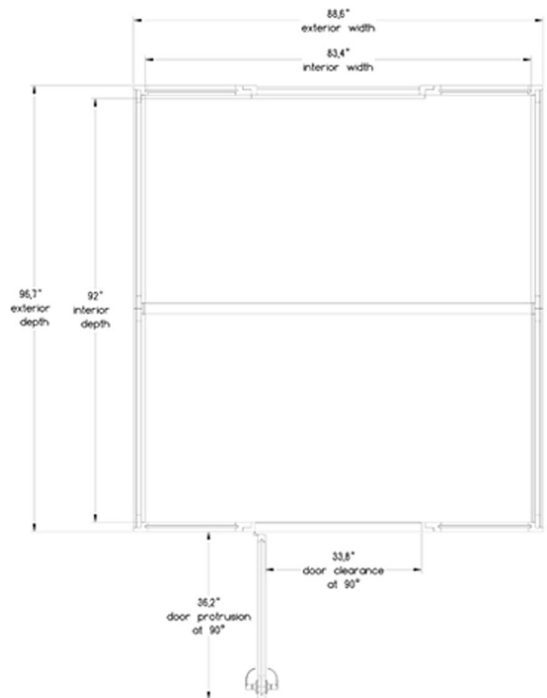



**Wall Mounted Power Module**

Customizable power module with switches for lights and ventilation, 110 volt power outlet USB ports and optional data port.

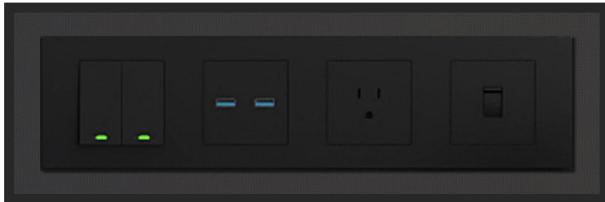

**LED Lighting**

2 energy efficient LED lights 3500k lumens (or custom upon request).

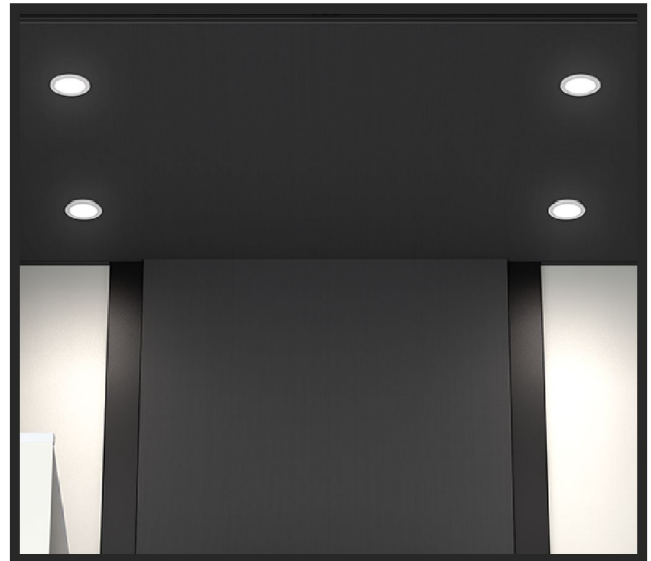

**Plug & Play Power Cord**

6-8ft (or longer if required) 3 prong power cord that plugs into a standard 110 volt outlet. Booth draws no more than 5 amps when turned on.

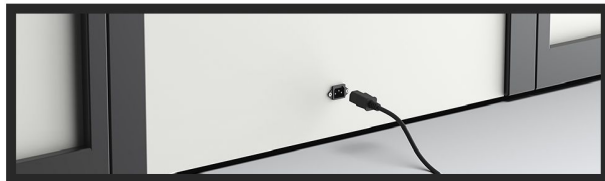

**Removable Side Panels:**

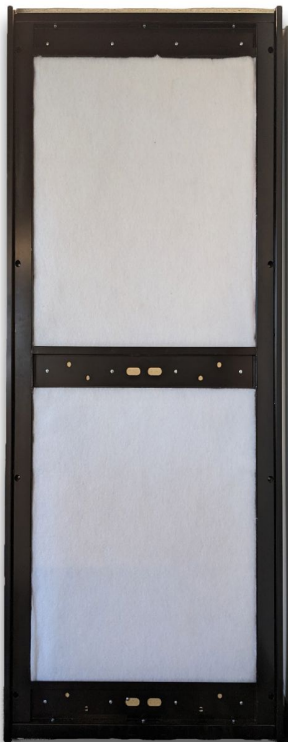

**Heavy Duty Hinges**

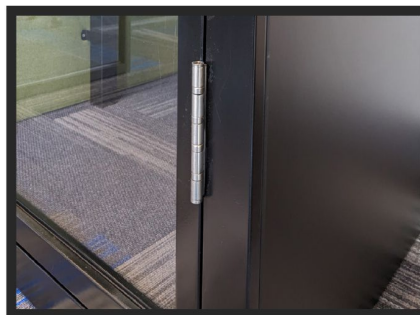

**Carpeting:** Charcoal Black carpeting (or custom upon request).



**Latching Door Handle:**

Heavy duty latching door handle or optional locking door handle.

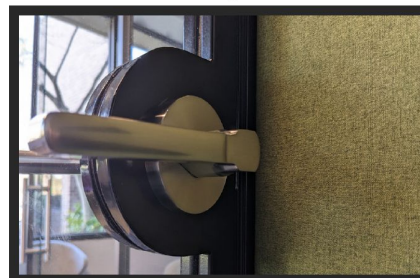

**Rubber Gasket Door:** Rubber gasket door seal designed to tightly seal door for extra soundproofing.

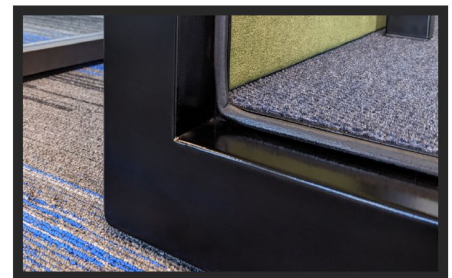

A better way to make your day, productive!

## Optional Features

### Counter Top:

Fixed height countertop, can be mounted at standing or sitting position or optional height adjustable for upcharge. Black woodgrain laminate.

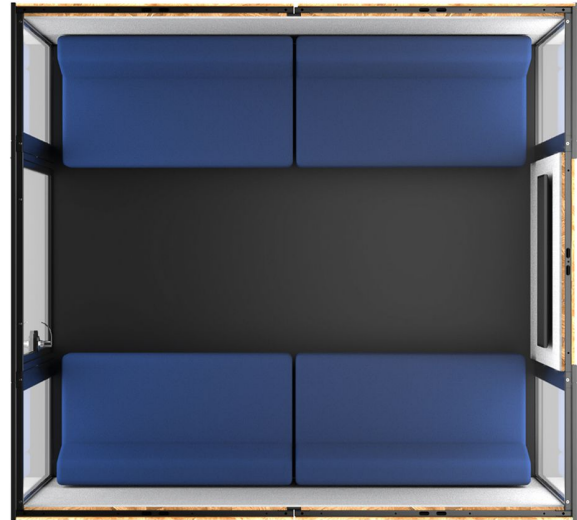

### Quietworx Upholstery:

Over 24 upholstery colors available for the interior walls. Upgrade from the standard felt.



### Woodgrain Side Panels:

Optional laminate woodgrain finish on the side panels or dry erase board.



### Height Adjustable Desk:

Optional height adjustable desk with black woodgrain laminate surface



# Optional:

Woodgrain side panels



Walnut Fiberwood   Unicorn White Wood   Planked Raw Oak   Planked Coffee Oak   Light Grey wood   Black Wood Grain

Quietworx upholstery colors



Whiteboard side panels



# Finishes:

Frame Color



White or Black

Side Panels

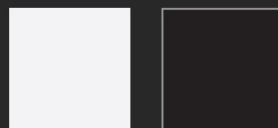

White or Black

Interior

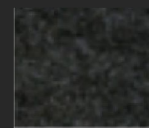

Charcoal Felt



A better way to make your day, productive!



Contact us

 [info@spaceworx.us](mailto:info@spaceworx.us)

 [spaceworx.us](http://spaceworx.us)

 +1 (866) 895-6044

**Spaceworx® For You**