



## Decibel® Double

### Escape the open office

The bigger brother to the Decibel® Single acoustical office phone booth. All of the extra space makes it ideal for meetings and work sessions for up to four users. It retains all the comforts, equipment, and sound attenuation that the Single booth is renowned for!



## Differentiators

KEEPING YOU COOL

### QuietFlow™

Our proprietary QuietFlow™ system is designed to keep you cool by quietly circulating the air inside the booth while maintaining acoustical privacy.

The design of the Spaceworx QuietFlow™ airflow system allows the fresh air to flow in smoothly, powered by energy-efficient fans, and forcing stale air out through strategically positioned exhaust vents, ensuring that a proper balance oxygen level is maintained throughout the pod.

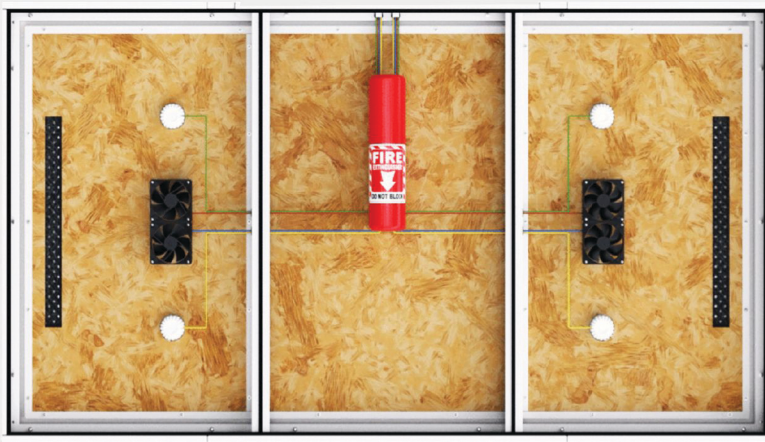

REDUCING DECIBELS

### QuietWorx™ Acoustics

Three layers of soundproofing material removes all distractions, giving everyone in the office a moment of peace.



## Technical Specifications



- **Exterior:** 85"H x 87"W x 48"D\*
- **Interior:** 79"H x 82"W x 44"D\*
- **Door:** 80"H x 36"W RH or LH
- **Weight:** Approx 1000 lbs
- **Power:** 6-8ft Power cord for Standard 110-120v outlet plug  
3500- 4500k LED lighting
- **Light switch for lighting & ventilation** (motion sensor optional)
- **Quietflow™ Ventilation** (2 fans)
- **Power Outlet & USB ports.**  
Optional data port
- **Passage latching door handle** (optional locking handle)
- **Acoustical rubber door seal**
- **Powered coated steel frame** (black or white)
- **High pressure laminate side panels** (black or white, woodgrains for upcharge)
- **Anti-shatter acrylic windows**
- **Charcoal PET acoustical felt**
- **Quietworx™ acoustical upholstery** (optional colors on walls)
- **Black Carpet**
- **Adjustable leveling feet**
- **Back panels, solid center, clear windows** on either side (solid optional)
- **MeetSmart™ lounge and table meeting configuration** (optional)
- **WorkSmart™ private office workspace configuration.** (optional)
- **Fireshield™** (patent pending) fire suppression system (optional)
- **Design Patent** (Pending)

\*Dimensions may vary slightly



# Privacy That Performs

**Front View**

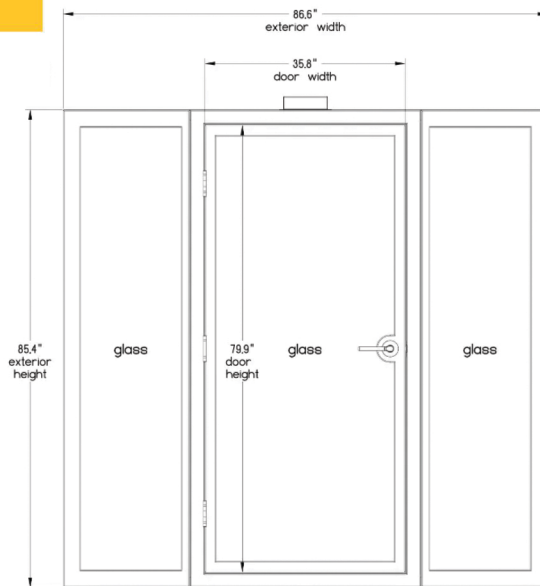

**Rear View**

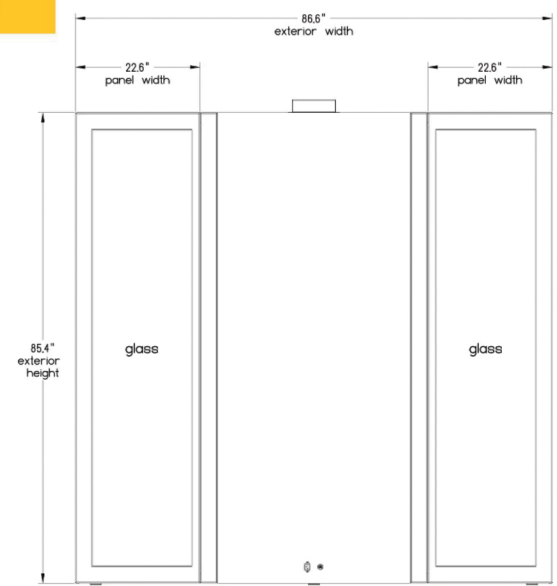

**Side View**

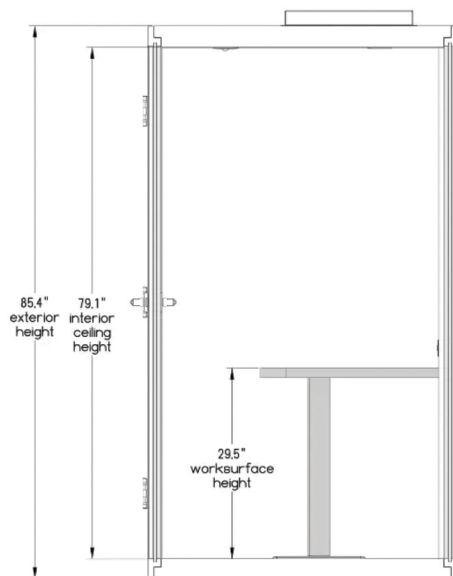

**Top View**

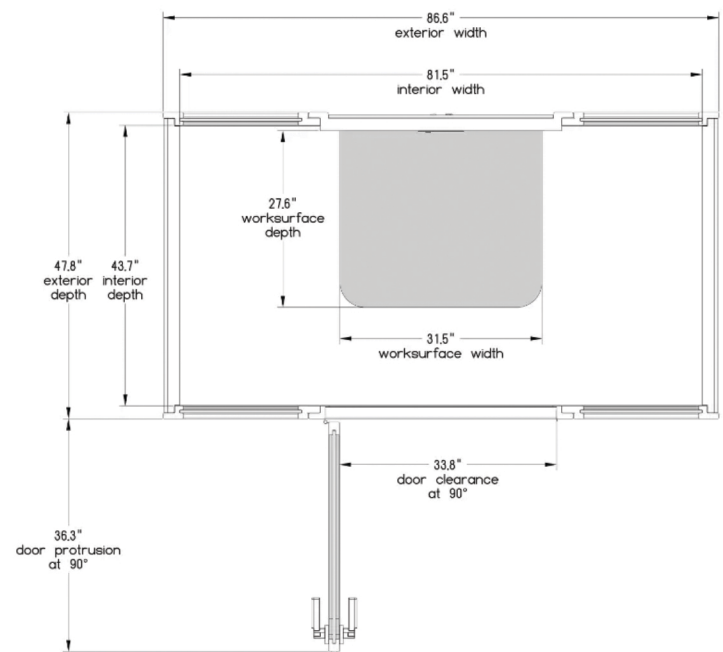



### Wall Mounted Power Module

Customizable power module with switches for lights and ventilation, 110 volt power outlet USB ports and USB-C port.



### LED Lighting

2 energy efficient LED lights 3500k lumens (or custom upon request).

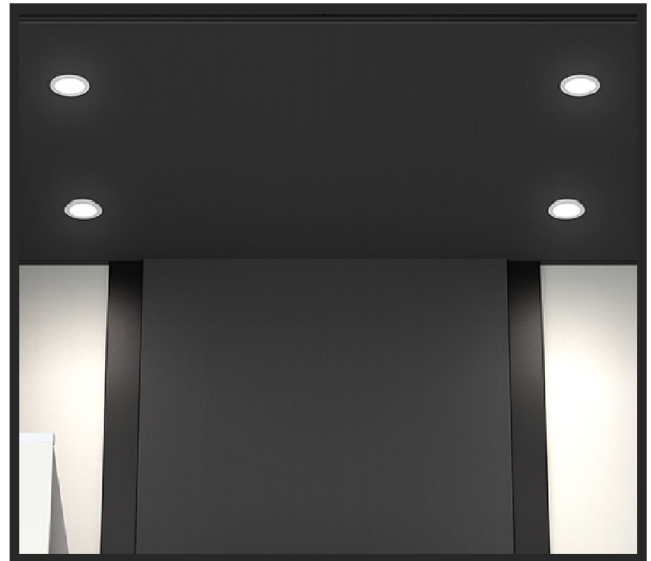

### Plug & Play Power Cord

6-8ft (or longer if required) 3 prong power cord that plugs into a standard 110 volt outlet. Booth draws no more than 5 amps when turned on.

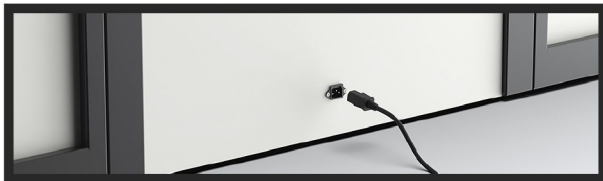

### Removable Side Panels:

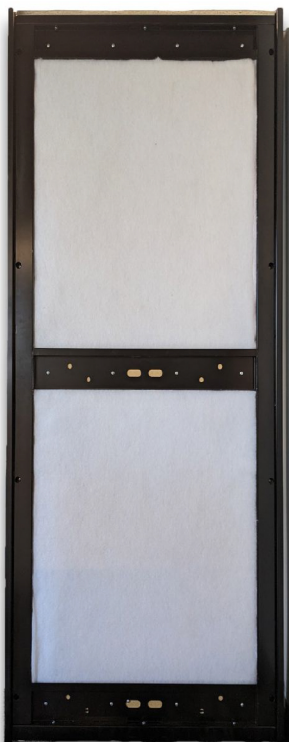

### Heavy Duty Hinges



### Latching Door Handle:

Heavy duty latching door handle or optional locking door handle.

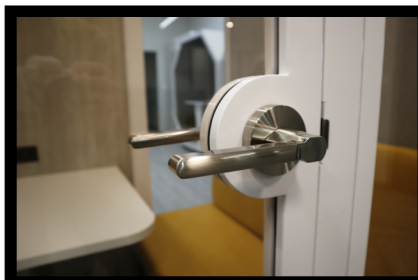

**Carpeting:** Charcoal Black carpeting (or custom upon request).

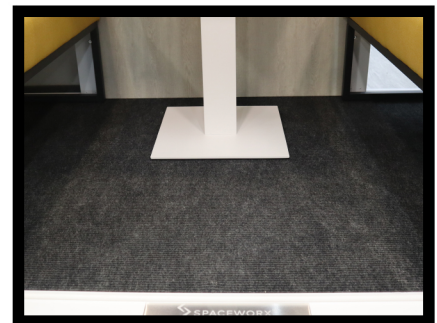

**Rubber Gasket Door:** Rubber gasket door seal designed to tightly seal door for extra soundproofing.

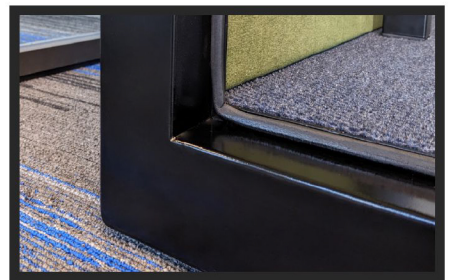



## Privacy That Performs

### Optional Features

#### Counter Top:

Fixed height countertop, can be mounted at standing or sitting position or optional height adjustable for upcharge. Black woodgrain laminate.

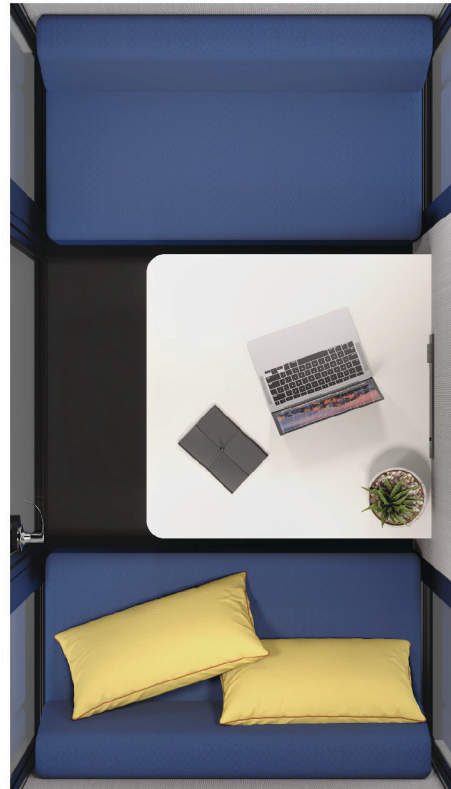

#### Quietworx Upholstery:

Over 24 upholstery colors available for the interior walls. Upgrade from the standard felt.



#### Woodgrain Side Panels:

Optional laminate woodgrain finish on the side panels or dry erase board.



#### Lounge Table:

Optional table offered in order to make the most out of the space.



## Optional:

Woodgrain  
side panels



Quietworx upholstery colors



Whiteboard side panels



## Finishes:

Frame Color



White or Black

Side Panels

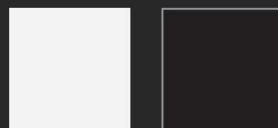

White or Black

Interior

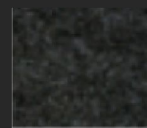

Charcoal Felt





Privacy That Performs



Contact us

✉ [info@spaceworx.us](mailto:info@spaceworx.us)

🌐 [spaceworx.us](https://spaceworx.us)

☎ +1 (866) 895-6044

